



Side screen

## **markilux 790**

Ideal, lateral protection against low-lying sun, light wind and inquisitive glances.

## Product properties



face fixture bracket for the front profile with angle for lateral fixture <sup>1)</sup>



docking post with welded-on base plate



sleeve assembly for insertion in the ground



safety mechanism for the handle fitted to the docking post

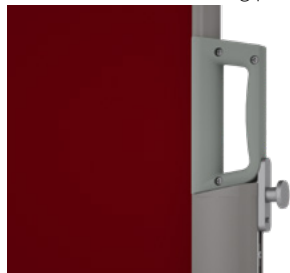

mobilfix: docking post fitted to a granite baseplate <sup>1)</sup>



docking bracket for front profile fitted to a railing



docking bracket for front profile fitted to a free-standing post or markilux pergola / pergola compact



detail at the top: pivoting option to fit the cassette to a free-standing markilux pergola / pergola compact post <sup>1)</sup>



detail at the bottom: pivoting option to fit the cassette to free-standing markilux pergola / pergola compact post <sup>1)</sup>



<sup>1)</sup> optional configuration

## Product properties

### Description

- the discretely shaped side screen giving allround protection to the cover thanks to the satisfactory, square cassette.

### Special features

- the height of the grip on the front profile can be adjusted to the exact conditions on site – so that the front profile can be locked in position and the cover tension adjusted without a problem
- the pre-set tension in the spring mechanism can be adjusted on site to comply with the wishes of the customer
- The screen cover can be cut diagonally to order, in which case the front profile will be correspondingly shorter – giving perfect protection in combination with a markilux folding-arm awning or markilux pergola / pergola compact
- intermediate screen heights and a good choice of fixture options are available – to make them employable on a patio, a balcony or even free standing
- docking post for the front profile with integrated safety lock for the grip to prevent it being released inadvertently

### Dimensions

- awning in the standard version 173 cm / 213 cm / 250 cm in height
- extension: 200–450 cm (depending on the screen height and fabric pattern)
- intermediate sizes are available

### Roller tube and lateral bearings

- round roller tube Ø 63 mm with keyway, galvanised steel, with integrated, maintenance-free spring mechanism providing optimum cover tension
- the roller tube bearing is made of machine finished, rolled aluminium

### Awning profiles

- Extruded aluminium, in façade quality, powder coated
- cassette profile in one piece, 95 mm × 95 mm
- circular front profile Ø 32 mm

### Side caps

- end caps are made of high-quality plastic, dyed through or powder coated – at the spring end they are aluminium, powder coated
- the front profile end caps are made of high-quality plastic, dyed through in grey

### Fixture brackets

- cassette brackets for face or reveal fixture, fixture to a post (free standing or to the post of the markilux pergola / pergola compact / markilux syncra)
- brackets for the front profile: face fixture, docking post with ground sleeve / base plate for bolting down, mobilfix (mobile docking post on a base plate), brackets for fixture to a (balcony) railing
- grip for front profile made of high-quality plastic, dyed through in grey
- adapter sets for fixture to Krinner screw-in foundations

## Frame colours

### markilux awning colours without surcharge

traffic white RAL 9016



metallic aluminium RAL 9006

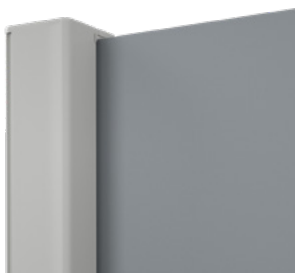

grey brown, similar to RAL 8019

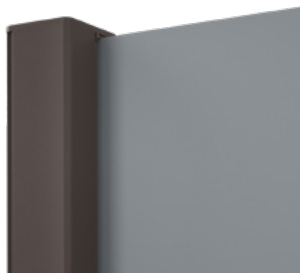
off-white textured finish, 5233 <sup>1)</sup>stone grey metallic, 5215 <sup>1)</sup>anthracite metallic, 5204 <sup>1)</sup>Havana brown textured finish, 5229 <sup>1)</sup>

**16**

17

### Non-standard powder-coated finish

Bespoke frame colours at a surcharge – matt, metallic and pearl finishes as well as other colour ranges (DB, Tiger etc.) on request. All frame colours are available at a surcharge with enhanced corrosion protection.

**1)** textured finish

Colours may differ slightly from those depicted in both hue and finish.

## Dimensions and configuration options

### Single unit

		Extension				
		250	300	350	400	450 <sup>1)</sup>
Order dimensions		200 — 250	251 — 300	301 — 350	351 — 400	401 — 450
GH	173 <sup>2)</sup>					
	213					—
	250					—

dimensions in cm

1) = angled top edge not possible

2) = minimum height 90 cm

GH = overall height (cassette height + 30 mm)  
intermediate sizes are available at surcharge

= cover height approx. 162 cm



= cover height approx. 202 cm



= cover height approx. 239 cm

### Operation

	standard	optional
manual extension	✓	—
cover exit to the right	✓	—
cover exit to the left	—	✓

### Awning cover

	fabric range no.	standard	optional	overall height	extension	tailored cloth
sunvas	301.. / 309..–315..	✓	—			SN
sunsilk	324.. / 325.. / 328.. / 369..	✓	—			SN
transolair	338..	—	✓		≤ 240	N
					> 241	SN
vuscreen Alu	317..	—	✓	≤ 213	≤ 240	N
				≤ 213	≥ 241 ≤ 300	SN
perfortex	331.. / 332..	—	—			
perla	370..	—	—			
perla FR	374.. / 375..	—	—			
Soltis Perform 92	92–20..	—	—			

dimensions in cm

N = Seamless

SN = vertical seam, panel width 120 cm

Fixture brackets		Fixture brackets	
face fixture bracket 50 mm	78758.	cassette bracket for reveal fixture 50 mm	77845.
wall docking option	77822.	angled bracket for lateral face fixture 175 × 60 × 60 mm	77987.
docking bracket for front profile with clamp for fixture to a railing Ø 40–45 mm	77984.	free-standing post 1730 mm–1830 mm Ø 70 mm with footplate for cassette fixture	71175.
docking bracket for front profile with clamp for fixture to a railing Ø 45–50 mm	77985.	brackets for fixture of the cassette to the markilux pergola / pergola compact	71174.
docking post with welded footplate 950 mm	77820.	bracket for fixture of the front profile to a post Ø 70 mm	71136.
docking post with ground sleeve 950 mm	77821.	brackets for fixture of the cassette to a square post of the markilux syncra	72231.
		brackets for fixture of the cassette to a round post of the markilux syncra	72208.
		mobilfix granite including docking post	778211
		mobilfix concrete including docking post	76838.
		adapter set for post fixture to a Krinner screw-in foundation <sup>1)</sup>	
		adapter set for front profile fixture to a Krinner screw-in foundation <sup>1)</sup>	

Dimension overview, cover with diagonally cut top edge

Please give the dimensions indicated when ordering

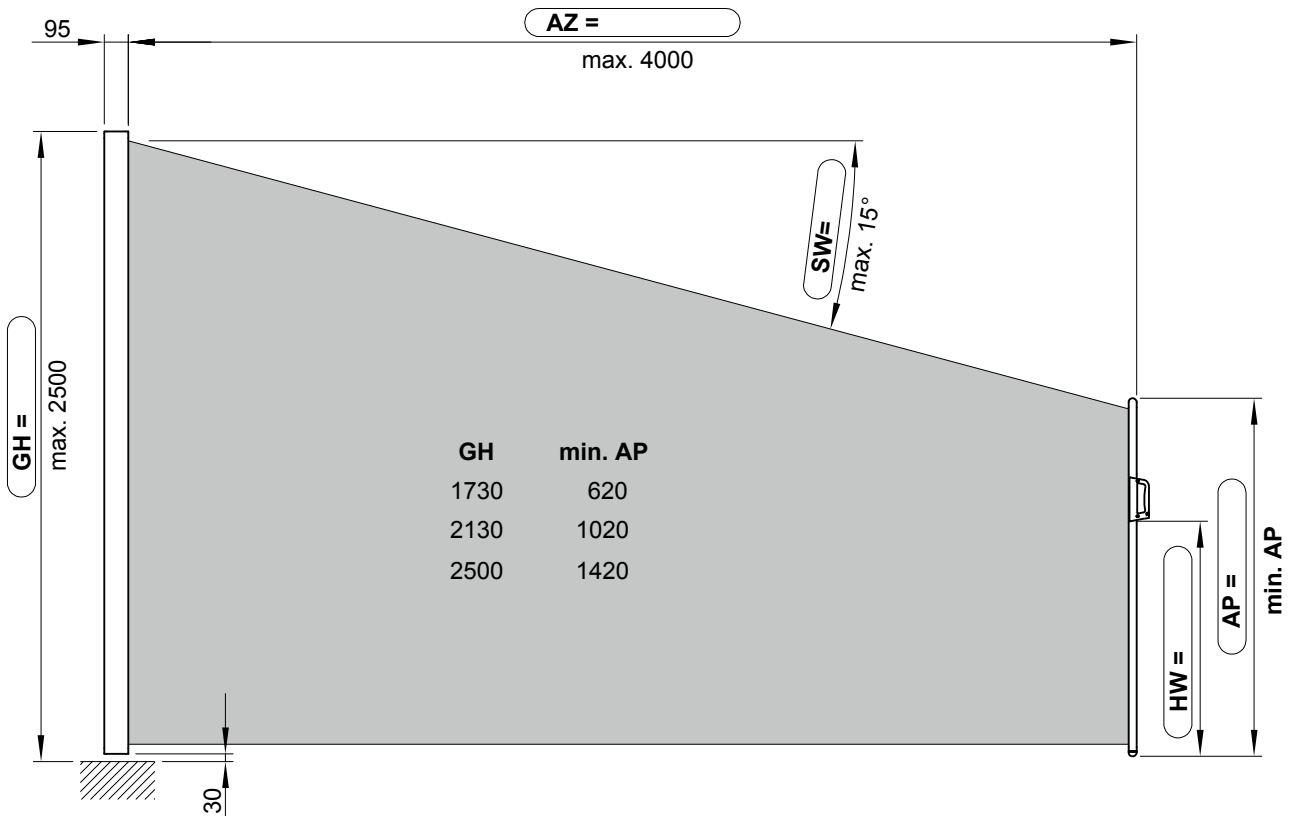

- 1)

= for a detailed description see the separate markilux sales documentation “Krinner – the screw-in foundation”
- AP

= height of the front profile
- AZ

= order measurement = extension
- GH

= order measurement = overall height side screen
- HW

= height of the wall docking bracket
- SW

= angle of the top edge of the cover
- dimensions in mm



## Dimension overview, standard cover

Docking post with welded bottom plate, ground sleeve or face fixture bracket

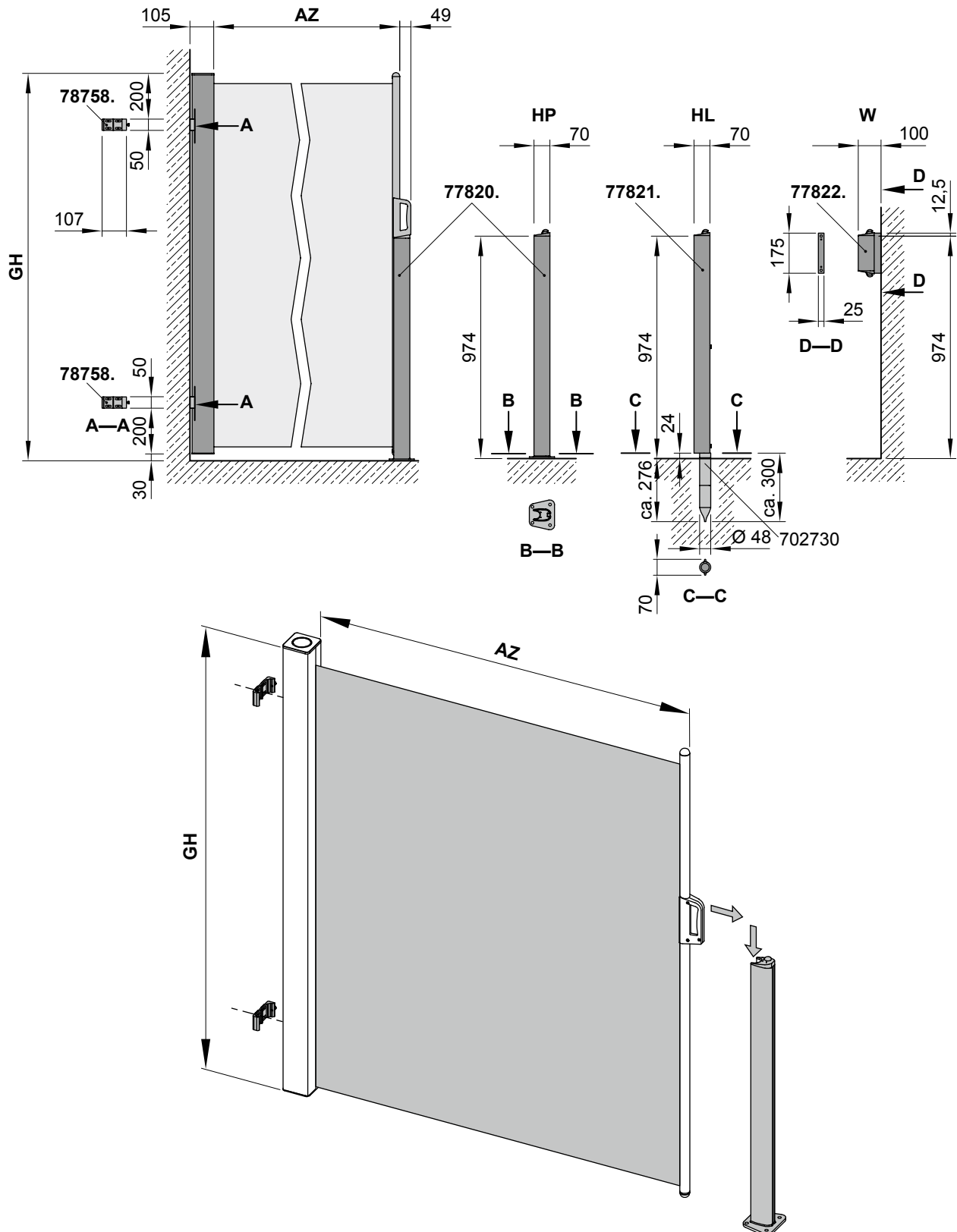

- AZ = order measurement = extension  
 GH = order measurement = overall height side screen  
 HL = sleeve assembly for insertion in the ground  
 HP = docking post for fixture to solid surface  
 W = face fixture

dimensions in mm

# Face fixture, face fixture bracket for the cassette

Fixtures, fittings and accessories

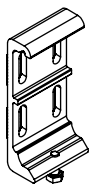

Face fixture bracket  
50 mm

78758.

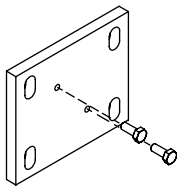

spreader plate  
120 × 100 × 10 mm

78982.

Cover exit to the right standard (see figure) – cover exit to the left optional

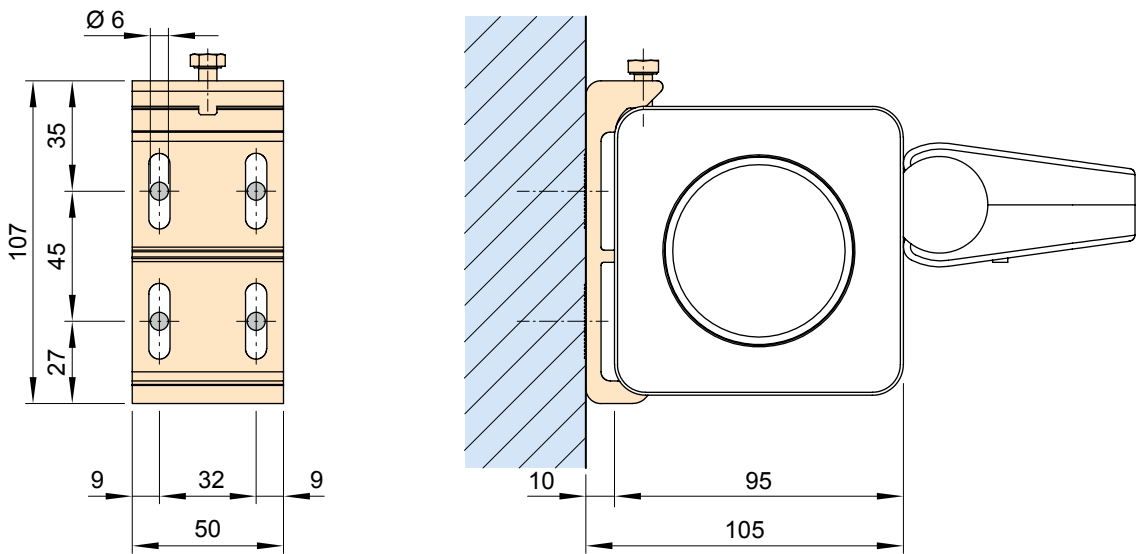

## 16

Spreader plate for universal bracket assembly

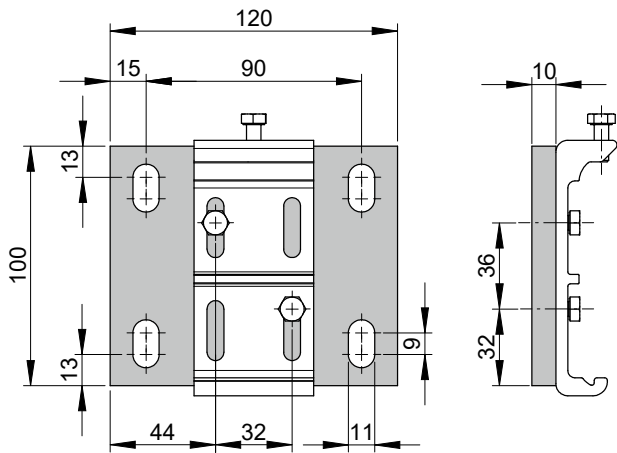

dimensions in mm



Face fixture, face fixture bracket for the cassette

Fixtures, fittings and accessories

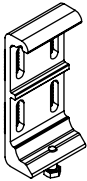

Face fixture bracket  
50 mm

78758.

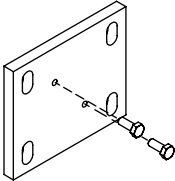

spreader plate  
120 × 100 × 10 mm

78982.

Cross section view with face fixture bracket for the front profile

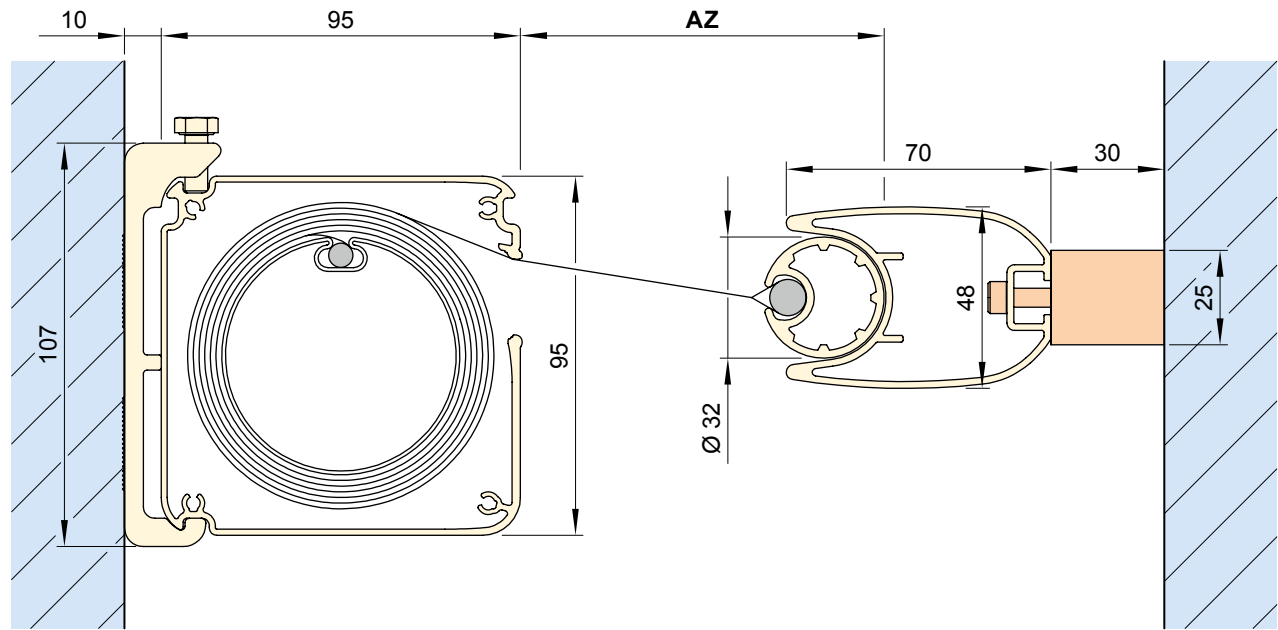

# Face fixture, face fixture bracket for the front profile

Fixtures, fittings and accessories

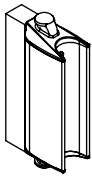

Face fixture bracket for the front profile

77822.

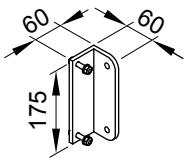

face fixture bracket assembly for the front profile 77822.

175 × 60 × 60 mm

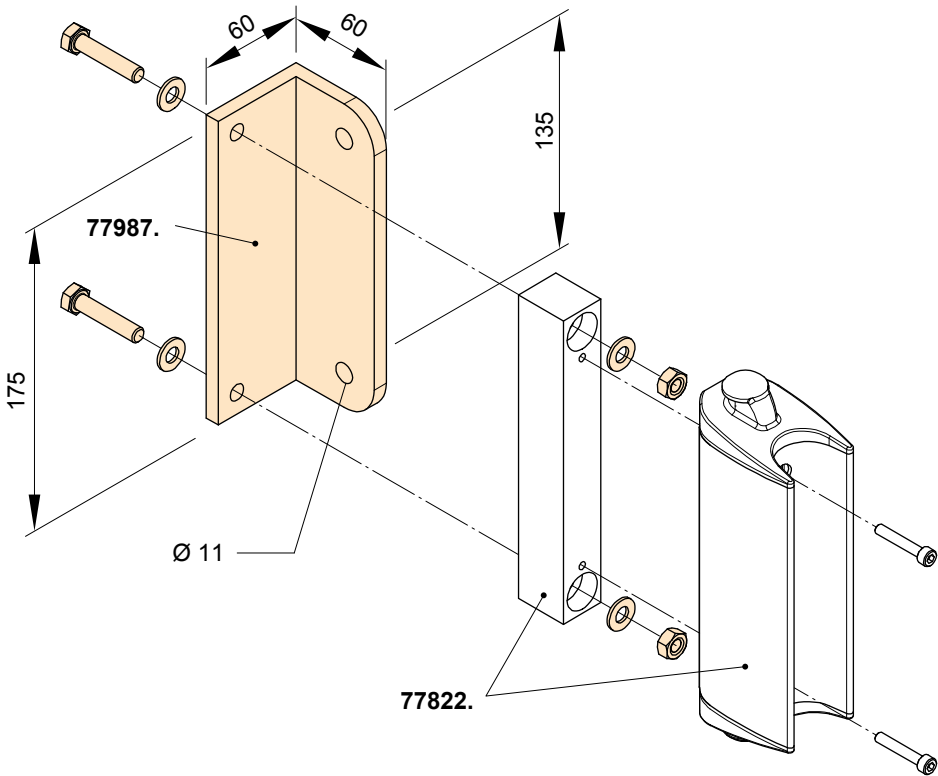
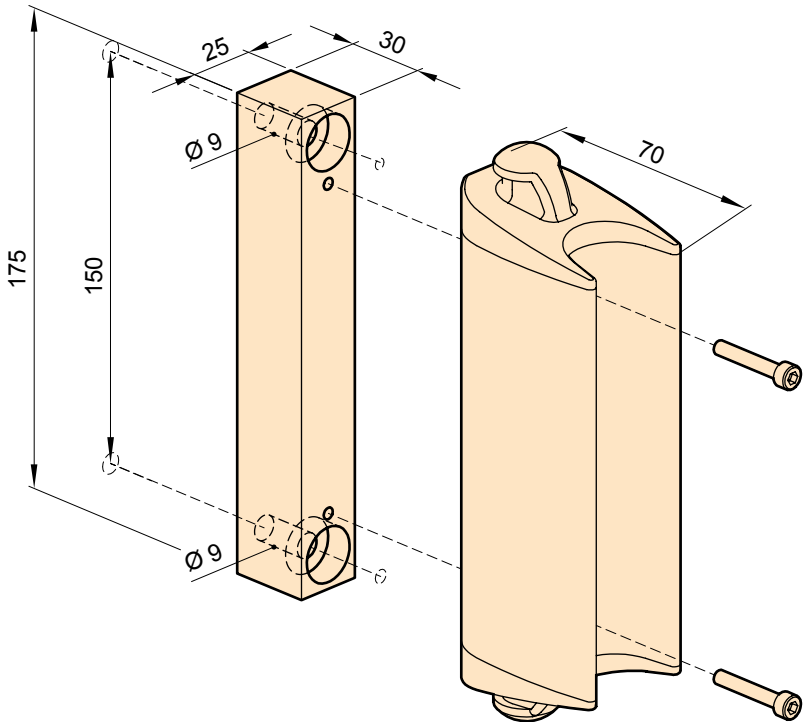

77987.



dimensions in mm

Docking post for front profile

Fixtures, fittings and accessories

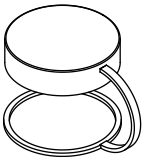
 <p>docking post assembly for the front profile with welded base plate</p> <p>77820.</p>	 <p>docking post assembly (for the front profile) for the ground sleeve</p> <p>77821.</p>	 <p>ground sleeve</p> <p>702730</p>
 <p>covering cap for ground sleeve</p> <p>702851</p>		

With a footplate for fixture to a solid surface (77820.)

With connecting profile and ground sleeve (77821.)

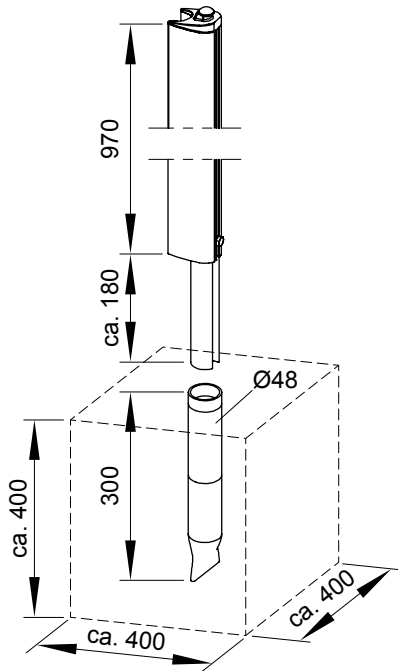
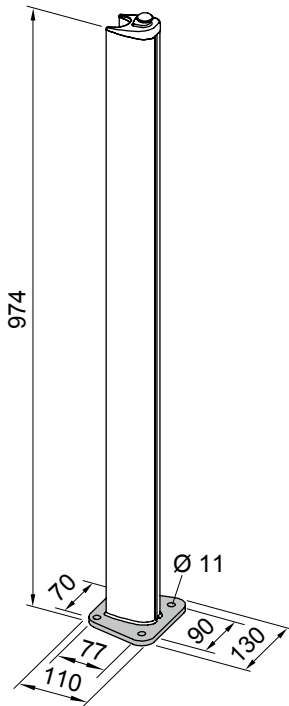

dimensions in mm

# mobifix

## Fixtures, fittings and accessories

 <p>mobifix: docking post mounted on a granite base plate 1) approx. 40 kg</p> <p>77821.   778941   778931</p>	 <p>Additional granite slab for the mobilfix (recommended in light wind) approx. 39 kg</p> <p>779311</p>	 <p>mobifix 2: docking post mounted on a concrete base plate approx. 55 kg</p> <p>76838.</p>
---	---	---

Granite is a natural stone and can vary in colour and structure.

**Note:** The markilux mobilfix is only to be used up to a maximum screen height of (GH) 213 cm.

mobifix

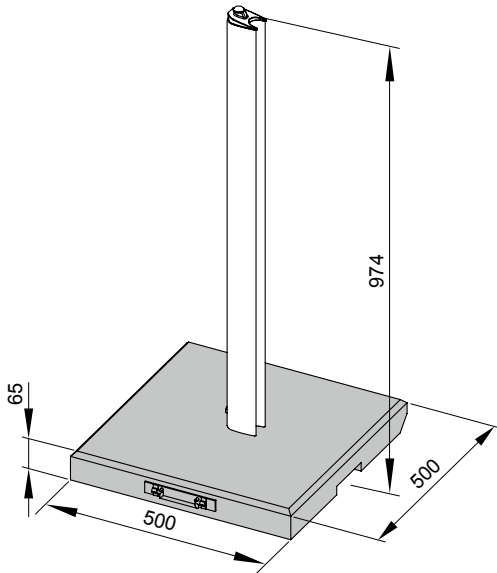

mobilefix with additional granite slab to weigh it down

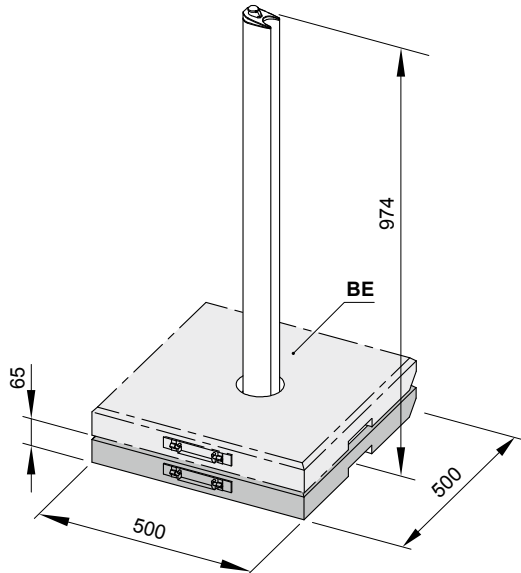

mobifix 2

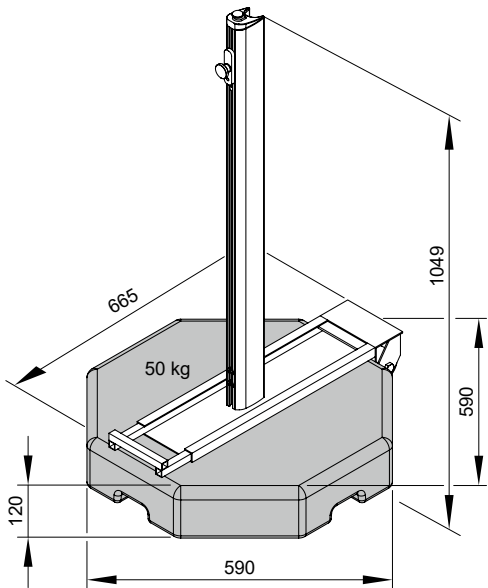

transport function mobilfix 2

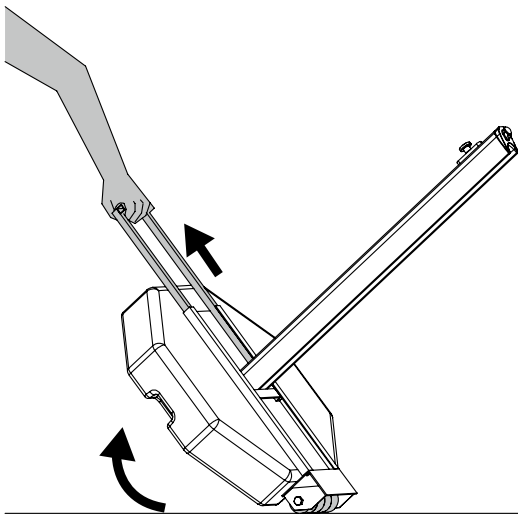

BE = additional granite slab to weigh it down (optional)

dimensions in mm

Railing bracket assembly for front profile

Fixtures, fittings and accessories

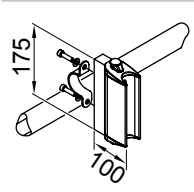

Technical drawing of railing bracket assembly 77984. It shows a side view of the bracket with dimensions: a vertical height of 175 mm and a horizontal width of 100 mm. The drawing is labeled 'railing bracket assembly' and 'Ø 40-45 mm'.

77984.

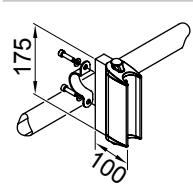

Technical drawing of railing bracket assembly 77985. It shows a side view of the bracket with dimensions: a vertical height of 175 mm and a horizontal width of 100 mm. The drawing is labeled 'railing bracket assembly' and 'Ø 45-50 mm'.

77985.

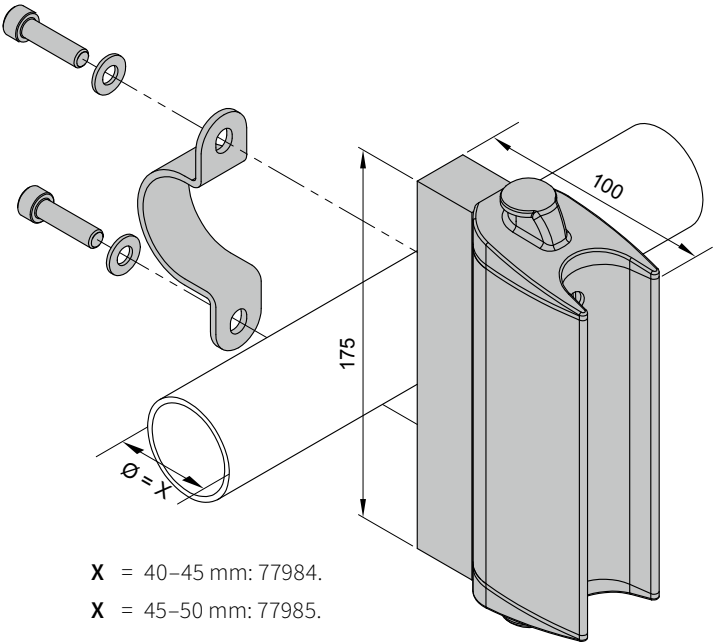

dimensions in mm

# Front profile fixture to a post

## Fixtures, fittings and accessories

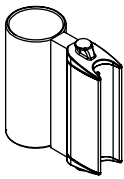

face fixture bracket  
for the front profile  
for markilux pergola /  
pergola compact round

71136.

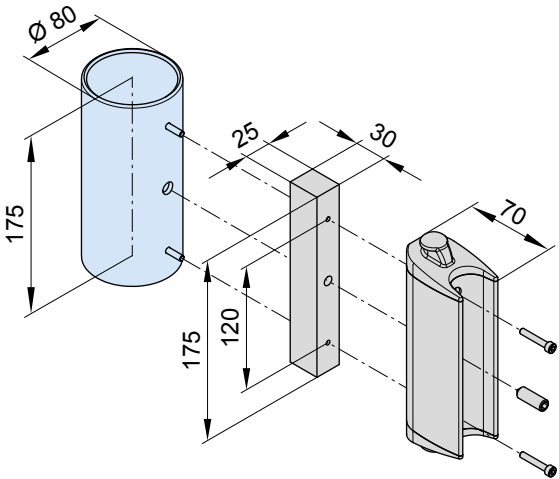

## Fixtures, fittings and accessories

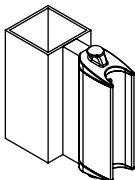

face fixture bracket  
for the front profile  
for markilux pergola /  
pergola compact square

75279.

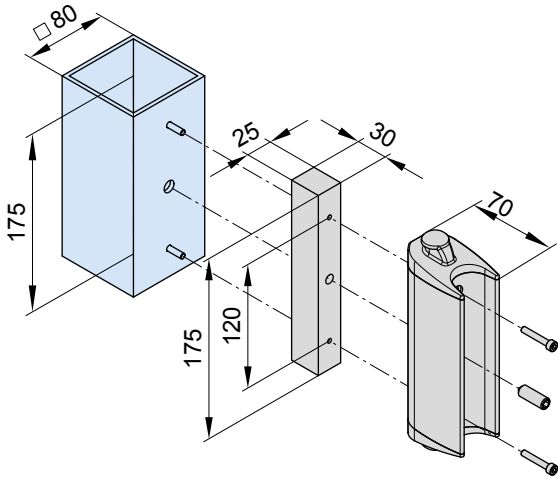

dimensions in mm

Cassette fixture to a post

Fixtures, fittings and accessories

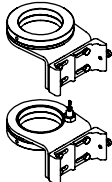
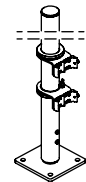
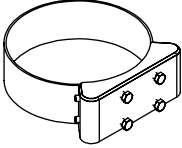
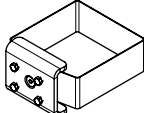
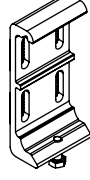
 <p>post with base plate</p> <p>overall height adjustable from approx. 1730 mm to 1830 mm, Ø 70 mm</p> <p>71172.</p>	 <p>universal fixture bracket: for cassette fixture to the post of the markilux pergola / pergola compact, 2 pieces</p> <p>height approx. 80 mm Ø 70 mm</p> <p>71174.</p>	 <p>post 71172 including base plate 71174.; fixture assembly for universal bracket for cassette overall height adjustable</p> <p>overall height adjustable approx. 1730–1830 mm, Ø 70 mm</p> <p>71175.</p>
 <p>fixture assembly for universal fixture bracket 78758. to the post of the markilux syncra 2</p> <p>width 52 mm, for post fixture Ø 140 mm, round post</p> <p>72208.</p>	 <p>fixture assembly for universal fixture bracket 78758. to the post of the markilux syncra</p> <p>width 52 mm, for square post 125 × 125 mm</p> <p>72231.</p>	 <p>face fixture bracket</p> <p>50 mm</p> <p>78758.</p>

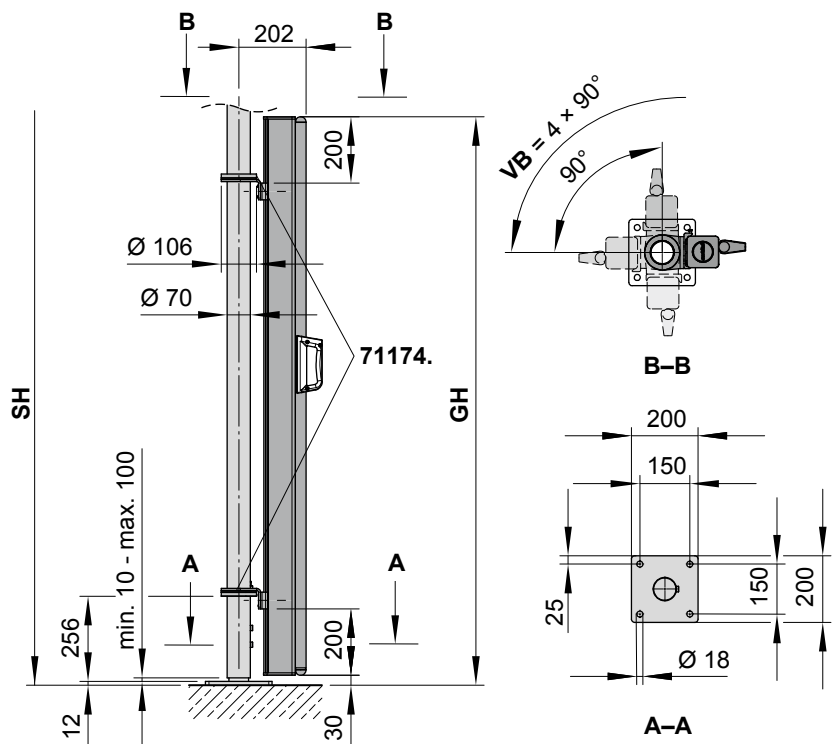

GH

= order extension = overall height

SH

= support post height

VB

= adjustment range (VB) of the fixture brackets with locking lever (4 × 90°)

dimensions in mm



# Reveal fixture of the cassette

Fixtures, fittings and accessories

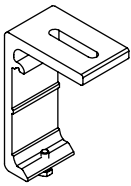

reveal fixture bracket  
assembly  
50 mm

77845.

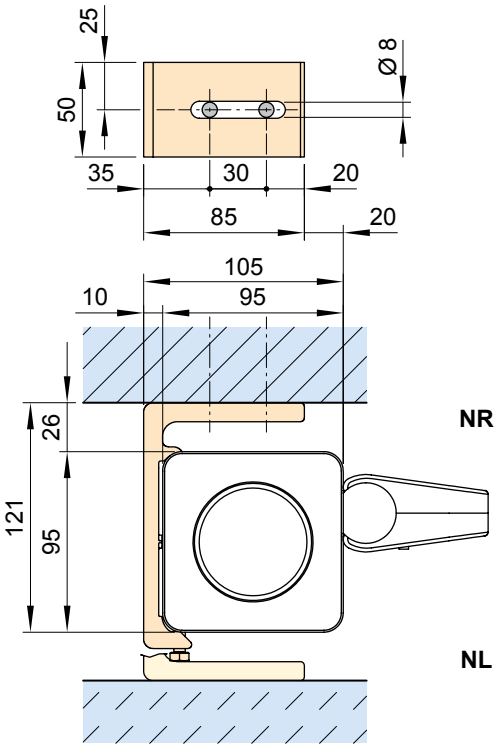

NR = reveal fixture right  
NL = reveal fixture left

dimensions in mm